

SURNO.lee

2.4G Wireless Numeric Keypad

Model: NK606

SPECIFICATION

Model: NK606

Number of keys: 35 keys

Working voltage: 3.0~4.2V

Input: 5V $\overline{\text{---}}$ 100mA(Min)

Battery capacity: 250mA/0.93Wh

Working distance: 32.8ft(Max)

Size: L5.7*W4.7*H0.8 inches(Max)

Keyswitch life: 10 million strokes times

Working frequency: 2405MHz~2470MHz

Compatibility: Windows XP/Vista/7/8/
10/11/Android / iMac

NOTE

1. Please charge for 10 minutes before first usage.
2. When the numeric keypad is not been used for long time, please power off.
3. There is a battery inside the keypad, please do not keep the keypad working in a high-temperature environment.
4. If any the fluid infiltrates the keypad, please switch off power promptly.

SPECIAL FUNCTION KEYS

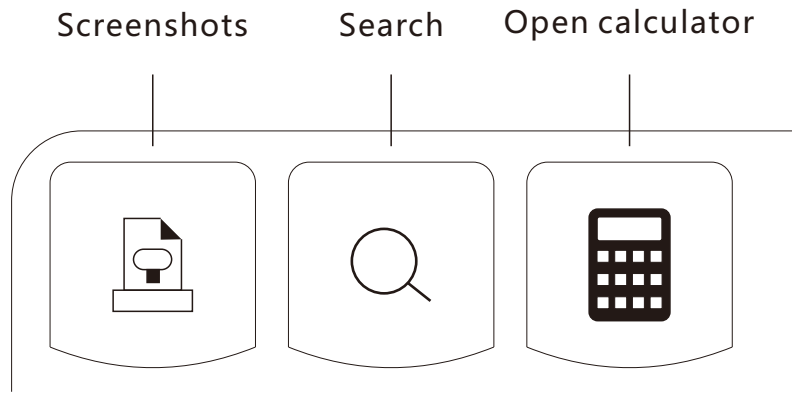

One-click screenshot



Search key, only applicable to system search and browser search.



Open calculator

INDICATOR LIGHT DESCRIPTION

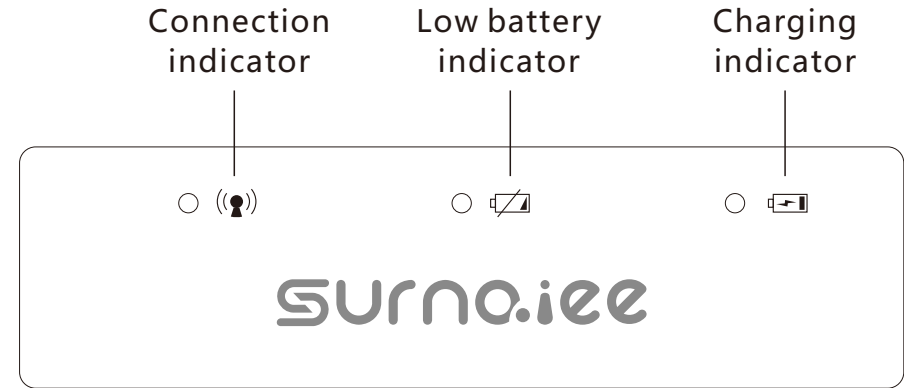

The green light turns on for 3 seconds and then turns off, and the connection is successful.



The red light flashes when the battery is too low; please charge the numeric keypad.



The blue light is on, and charging is in progress; the blue light is off, and charging is complete.

OPERATION (一)

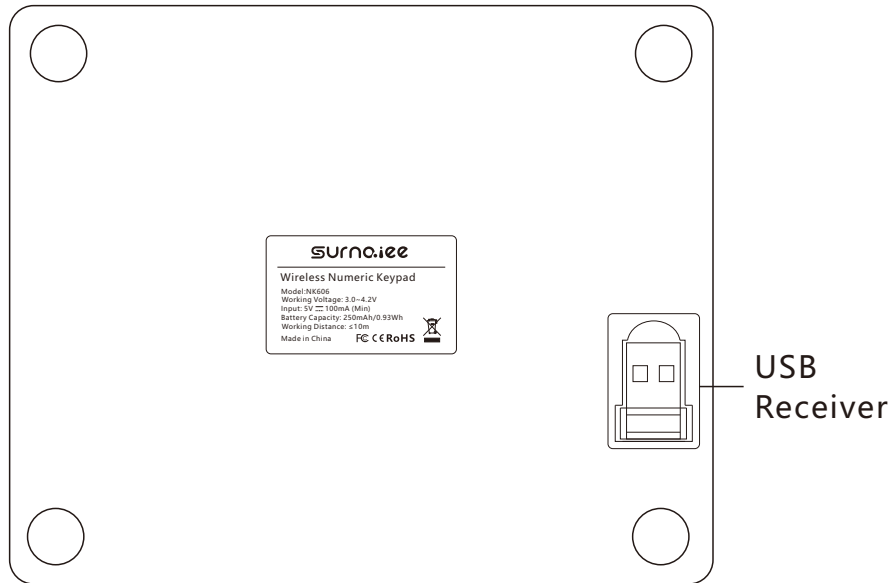

1. Take out the USB receiver on the back of the numeric keypad.

OPERATION (二)

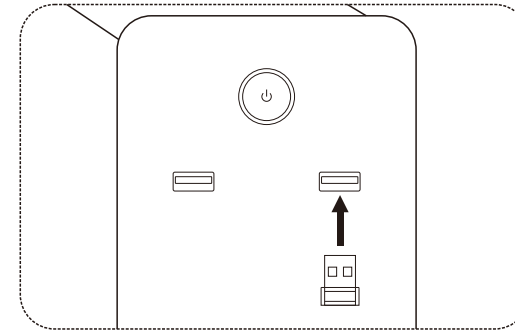

2. Connect the USB receiver to the computer.

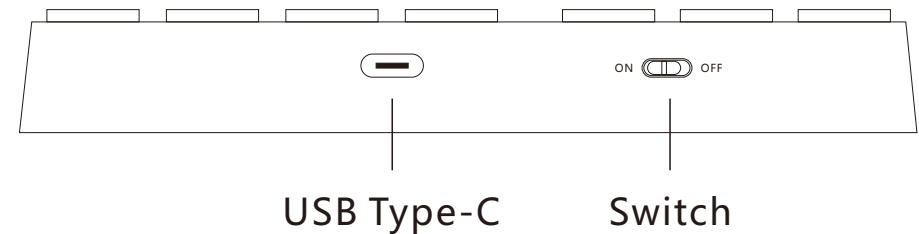

3. Turn on the switch, the connection indicator lights up for 3 seconds and then goes out, and the numeric keypad starts to work.

FCC WARNING

This device complies with part 15 of the FCC Rules. Operation is subject to the following two conditions: (1) This device may not cause harmful interference, and (2) this device must accept any interference received, including interference that may cause undesired operation.

Any Changes or modifications not expressly approved by the party responsible for compliance could void the user's authority to operate the equipment.

Note: This equipment has been tested and found to comply with the limits for a Class B digital device, pursuant to part 15 of the FCC Rules. These limits are designed to provide reasonable protection against harmful interference in a residential installation. This equipment generates uses and can radiate radio frequency energy and, if not installed and used in accordance with the instructions, may cause harmful interference to radio communications. However, there is no guarantee that interference will not occur in a particular

installation. If this equipment does cause harmful interference to radio or television reception, which can be determined by turning the equipment off and on, the user is encouraged to try to correct the interference by one or more of the following measures:

- ▶ -Reorient or relocate the receiving antenna.
- ▶ -Increase the separation between the equipment and receiver.
- ▶ -Connect the equipment into an outlet on a circuit different from that to which the receiver is connected.
- ▶ -Consult the dealer or an experienced radio/TV technician for help.

The device has been evaluated to meet general RF exposure requirement. The device can be used in portable exposure condition without restriction.

TROUBLESHOOTING

Question	Solution
Computer does not recognize	<ol style="list-style-type: none">1. After the numeric keypad is connected to the computer, restart the computer.2. Reconnect in the following order:<ol style="list-style-type: none">A. Connect the USB receiver to the computer.B. Turn on the numeric keypad's power.
Input intermittently	<ol style="list-style-type: none">1. The battery is too low (the red indicator light flashes), please charge the numeric keypad.2. Keep away from high-power electrical appliances or radio interference equipment.
No response to keystrokes	<ol style="list-style-type: none">1. The battery is exhausted. Please charge the numeric keypad.2. Reconnect the USB receiver to the computer.3. Re-pair:<ol style="list-style-type: none">①. Remove the USB adapter from the computer.②. Turn on the power switch of the numeric keypad and simultaneously press the "Esc" key and the "0" key until the connection indicator flashes rapidly.③. Connect the USB adapter to the computer.④. The connection indicator flashes slowly three times, and the pairing is successful.

SURNQ.IEE

SURNQIEE CO.,LTD

Website: www.surnqiee.com

E-Mail: support@surnqiee.com